

Morgans

PROPERTY

44 Tulloch Court, Cowdenbeath, KY49SD

Offers Over £80,000







Ideal opportunity to purchase this top floor flat with lovely views overlooking playing fields, with local amenities and schools close by. The property would ideally suit first time buyers or Investors. The accommodation comprise of communal door entry intercom, entrance hall, lounge, modern kitchen, two double bedrooms, one with fitted wardrobes, bathroom with electric shower over bath. The property benefits gas central heating, double glazing, residents parking and communal garden/drying green to the rear.





LOCATION

Cowdenbeath is located approximately five miles northeast of Dunfermline. The town boasts a good selection of shops, modern leisure centre, golf course and further recreational facilities. The primary and secondary schools are easily accessible. It has its own railway station connecting with both Dunfermline and Edinburgh. The town has easy access to the M90 and A92 motorway network, which makes commuting particularly easy.

EXTRAS INC IN SALE / AGENTS NOTE

All floor coverings, blinds, bathroom and light fittings together with appliances and garden shed.

From 1st February 2022, residential properties in Scotland are required by law to have installed a system of inter-linked smoke alarms, carbon monoxide detectors and heat detectors (the "inter-linked system"). No warranty is given that any interlinked system has been installed in this property and interested parties should make their own enquiries.





Tulloch Court, Cowdenbeath, KY4 9SD

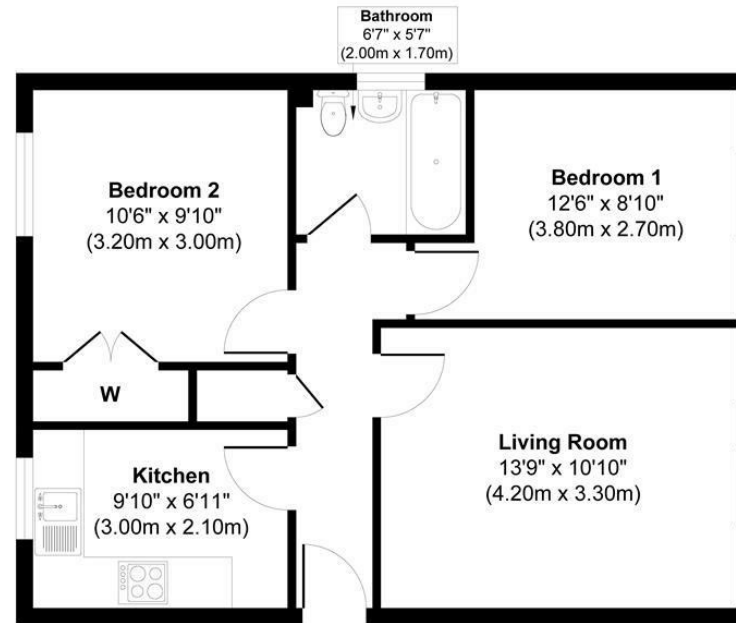

Approximate Floor Area
545 sq. ft
(50.63 sq. m)

Morgans

PROPERTY

Approx. Gross Internal Floor Area 545 sq. ft / 50.63 sq. m

Illustration for identification purposes only, measurements approximate, not to scale. Copyright

Morgans

PROPERTY

SOLICITORS | PROPERTY

33 East Port, Dunfermline, Fife, KY12 7JE

Tel: 01383 620222 Fax: 01383 621213

www.morganlaw.co.uk



espc

rightmove

Zoopa.co.uk

onTheMarket.com

s1homes.com

naea | propertymark
PROTECTED

AGENTS NOTE These particulars do not form part of any contract and the statements or plans contained herein are not warranted nor to scale. Approximate measurements have been taken by electronic device at the widest point. Services and appliances have not been tested for efficiency or safety and no warranty is given as to their compliance with any Regulations. No movable items will be included in the sale.