



Morgans
PROPERTY

2 Mckenzie Crescent, Lochgelly, KY5 9LT
Offers Over £139,950







Keenly priced and well appointed within the town is this three bed semi detached villa with driveway for several vehicles and single garage. The outdoor space and gardens are easy to maintain and the rear garden is enclosed providing a child and pet safe environment with patio/seating areas. An excellent family home. The accommodation is well presented and briefly comprises entrance vestibule, front facing lounge leading to dining room together with fitted kitchen and door to gardens. On the upper level there are lovely views over the countryside with three double bedrooms and modern shower room. Good storage and access to attic. The property is double glazed with gas central heating.





LOCATION

Lochgelly town is to the east of Dunfermline. The town has local amenities and recreational facilities, including The Lochgelly Centre, a hub for the community, primary and secondary schooling, are within easy reach, as is the railway station. There are also good transport links making this an ideal location for commuters, with the A92 and M90 a short distance away. The towns of Cowdenbeath, Kirkcaldy and Dunfermline have extensive amenities and are within easy reach.

EXTRAS INC. IN SALE / AGENTS NOTE

All floor coverings, blinds, bathroom and light fittings together with integrated appliances, garden shed and greenhouse.

From 1st February 2022, residential properties in Scotland are required by law to have installed a system of inter-linked smoke alarms, carbon monoxide detectors and heat detectors (the "inter-linked system"). No warranty is given to the interlinked system installed in this property.







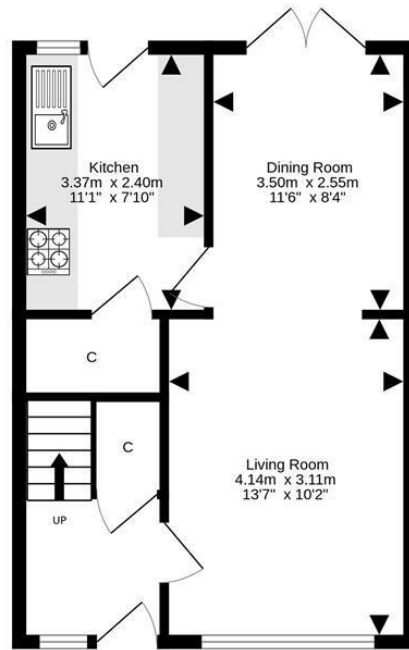
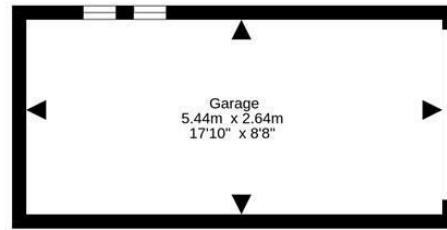

Ground Floor

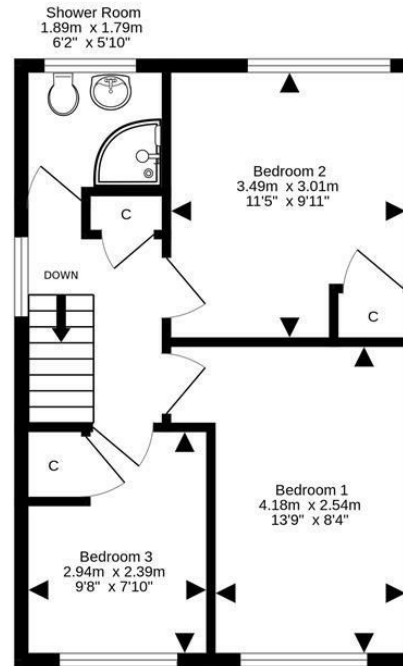

1st Floor



For details of the total internal floor area, please refer to the property's Home Report. This plan is for illustrative purposes only and should be used as such by a prospective purchaser.
Made with Metropix ©2024



SOLICITORS | PROPERTY

33 East Port, Dunfermline, Fife, KY12 7JE

Tel: 01383 620222 Fax: 01383 621213

www.morganlaw.co.uk



eSpC

rightmove

Zoopla.co.uk

onTheMarket.com

s1homes.com

naei | propertymark

PROTECTED

AGENTS NOTE These particulars do not form part of any contract and the statements or plans contained herein are not warranted nor to scale. Approximate measurements have been taken by electronic device at the widest point. Services and appliances have not been tested for efficiency or safety and no warranty is given as to their compliance with any Regulations. No movable items will be included in the sale.